

Model: Iris/Lilac 3bin Sorter		Date: 11-Dec-01	No.: MA849001
Modified Article: Antistatic Brush		Prepared by: M.Tsuyuki	
From: Technical Services Dept., GTS Division			
Reason for Modification:	<input type="checkbox"/> Parts catalog correction <input type="checkbox"/> To facilitate assembly <input type="checkbox"/> Part standardization	<input type="checkbox"/> Vendor change <input type="checkbox"/> To improve reliability <input checked="" type="checkbox"/> Other	<input type="checkbox"/> To meet standards (      )

Old part number	New part number	Description	Q'ty	Int	Page	Index	Note
AA120027	A8491661	Antistatic Brush	4	X/O	7 9 11	15 24 3	

The Antistatic Brush has been modified so that the fibers remain firmly attached to the brush, which will ensure that SC410 is not triggered when paper is re-fed from the bypass tray to print the 2<sup>nd</sup> side.

### 3. VERTICAL TRANSPORT (A849)

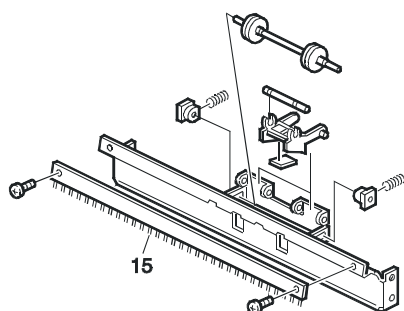

### 4. TRANSPORT AND DRIVE SECTION 1 (A849)

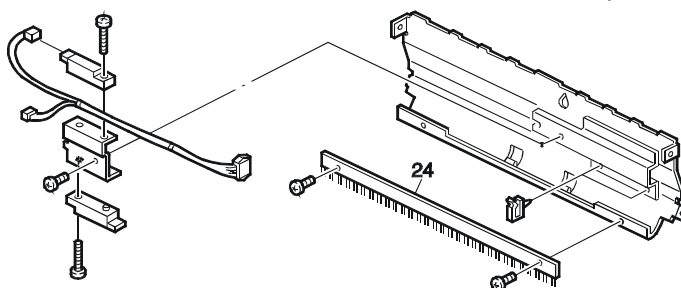

### 5. TRANSPORT AND DRIVE SECTION 2 (A849)

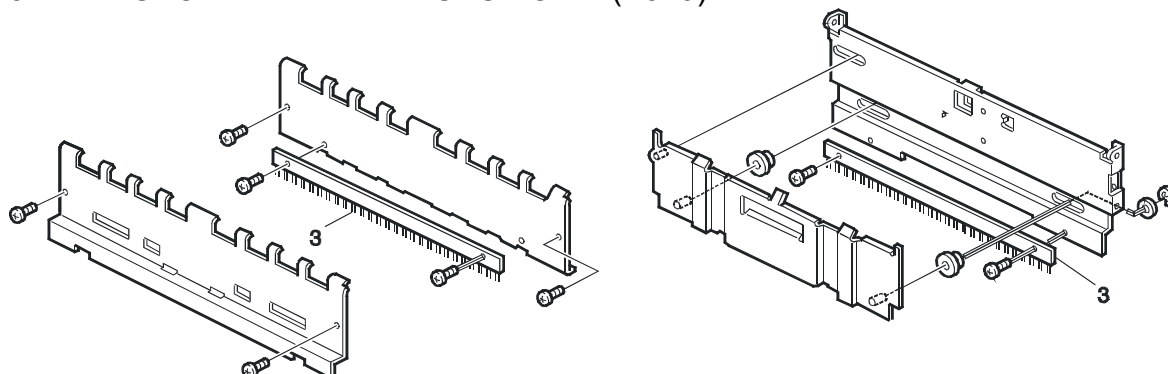

Model: Iris/Lilac 3bin Sorter

Date: 11-Dec-01

No.: MA849001

**RCL (Japan) Production**

MODEL NAME	V/Hz	DESTINATION	CODE	SERIAL NO.
CS160	120, 220-240V, /50,60Hz	USA, Canada. South America Europe, etc	A849-17	H0510500001
CS160	120, 220-240V, /50,60Hz	Europe, etc.	A849-26	From Next Production
CS160	220-240V, /50,60Hz	USA, Canada. Europe, etc	A849-55	L0431080001